

39002 Eurosert

Stainless steel · Low profile · Round · Open end
M4 - M5

Features

- Designed to provide load bearing threads in thin sheet materials
- Double diameter body and lead-in chamfer provide easy insertion into hole
- Low profile head allows near flush fit to application

Material

- Stainless steel, natural
(Werkstoff 1.4570)

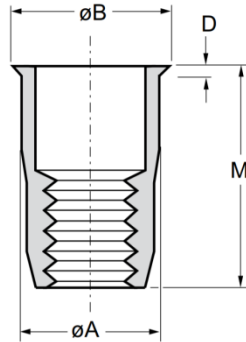

Before Placement

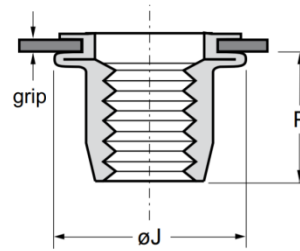

After Placement

Part No.	Thread Size	Grip Range		Hole Size	$\varnothing A$	$\varnothing B$	D	$\varnothing J$	M	P
		min.	max.	+0.1 / -0	max.	max.	max.	max.	max.	max.
39002-74020	M4 x 0.7	0.25	3.00	6.0	5.95	6.70	0.46	8.80	11.30	7.10
39002-75030	M5 x 0.8	0.25	3.00	7.0	6.95	7.80	0.46	10.20	12.70	7.90

Thread Size	Max. torque	Pull-out	Torque-to-turn	Push-out
	Nm max.	kN	Nm min.	kN
M4 x 0.7	5.6	9.8	1.8	1.8
M5 x 0.8	11.3	12.5	2.6	2.5



Can't find what you are looking for?

We can provide unique and customized solutions.
Contact your nearest [Gripwell](#) team for assistance!